

Singer 15-75

Form 20954  
(1057)  
Printed in U.S.A.

**LIST**  
OF  
**PARTS**  
FOR FAMILY SHOPS



**SINGER<sup>™</sup>**

**MACHINE No. 15-75**

---

**THE SINGER MANUFACTURING COMPANY**

\*\* A Trademark of THE SINGER MANUFACTURING COMPANY

PROPERTY OF  
THE SINGER MANUFACTURING COMPANY

This is a private and confidential communication to and for the use of only the employees of The Singer Manufacturing Company and its affiliated companies. Reproduction, sale, distribution, or publication thereof to the public is forbidden.

INDEX

	Page
Accessories .....	12
Attachment Set .....	15
Bias Gauge .....	13
Bobbin Winder .....	12
Braider .....	13
Feller (Foot) .....	13
Finger Guard .....	13
Hemmer Foot .....	13
Hemstitcher .....	13
Machine No. 15-75 .....	7
Numerical List of Parts .....	17
Presser Feet .....	13
Presser Foot with Adjustable Guides .....	14
Quilter .....	14
Ruffler Shirring Plate .....	14
Seam Guide .....	15
Special Attachments .....	16
Stiletto .....	15
Underbraider .....	15

## INSTRUCTIONS FOR ORDERING

In ordering from this list, use ONLY the part NUMBER in the FIRST column.

The number stamped on a Sewing Machine Part is in every case the number of the single part only.

Every combination of parts sent out as such has its specific number, which, although not stamped on the parts, must be used when ordering the combination.

Each number always indicates the SAME PART in whatever list it appears, or for whatever machine.

The letters after some of the numbers indicate the style of finish only, as follows:

- A—Hardened, Polished, Nickel Plated and Buffed
- B—Polished, Nickel Plated and Buffed
- C—Hardened Only
- D—Polished Only
- E—Soft, Not Polished
- F—Hardened and Polished
- G—Bright Rumbled and Nickel Plated
- H—Blued
- J—Nickel Plated Only
- K—Hardened and Nickel Plated
- L—Brass Plated
- M—Oxidized
- R—Phosphate Coating Formed on Surface of Iron or Steel
- S—Cadmium Plated
- T—Copper Plated
- U—Zinc Plated
- V—Silver Plated
- W—Polished and Nickel Plated
- X—Black Oxide for Iron and Steel
- Y—Black Nickel Plated Only
- Z—Chromium Plated
- A.A—Buffed and Chromium Plated
- A.B—Hardened, Polished, Buffed and Chromium Plated
- A.E—Hardened, Bright Rumbled and Nickel Plated
- A.F—Hardened, Bright Rumbled, Nickel Plated, Bright Rumbled and Chromium Plated
- A.G—Alumilite (Plain)
- A.H—Alumilite (Dyed) Color Must be Stated
- A.J—Polished, Nickel Plated and Chromium Plated
- A.K—Hardened, Polished, Nickel Plated and Chromium Plated
- A.L—Heat Treated for Toughness
- A.L.D—Heat Treated for Toughness and Polished
- A.L.X—Heat Treated for Toughness and Black Oxide

## INSTRUCTIONS FOR ORDERING

- A.S—Black Moulded Phenolic
- A.T—Beige Moulded Phenolic
- A.U—Brown Moulded Phenolic
- A.W—Hardened then Flame Coated with Tungsten Carbide
- B.A—Chrome Nickel Satin Finish
- B.B—Hardened and Chrome Nickel, Satin Finished
- C.R—Hardened and Phosphate Coating Formed on Surface of Steel
- F.J—Hardened, Polished and Nickel Plated
- T.A—Hardened, Polished, Copper and Nickel Plated and Buffed
- T.B—Copper and Nickel Plated and Polished
- T.J—Copper and Nickel Plated Only
- T.K—Hardened, Copper and Nickel Plated
- T.L—Copper and Brass Plated
- T.M—Copper Plated and Oxidized
- X.C—Hardened and Black Oxide for Iron and Steel
- Z.A—Hardened, Polished Nickel Plated, Buffed and Chromium Plated
- Z.B—Polished, Nickel Plated, Buffed and Chromium Plated
- Z.C—Hardened and Chromium Plated
- Z.D—Polished and Chromium Plated
- Z.G—Bright Rumbled, Nickel Plated, Bright Rumbled and Chromium Plated
- Z.J—Nickel and Chromium Plated
- Z.T—Copper and Chromium Plated

These letters MUST BE USED when they appear in the list; and AFTER the number as in the list.

In this series:

1 to 1500, 50001 to 51500 and 140001 to 142,000 are screw numbers  
1501 to 1800 and 51500 to 51800 are nut numbers  
1801 to 2000 and 51801 to 52000 are roller numbers  
2001 to 50000 and 52001 to 140000 and 142001 to 190000 are Sewing Machine Parts, 190001 and upward are numbers of Electrical Parts.

The figures in the second column refer only to the plates, illustrating the parts, and are NOT TO BE USED in ordering.

Parts marked with an asterisk (\*) are furnished only when repairs are made at the factory.

LIST OF PARTS COMPLETE  
FOR

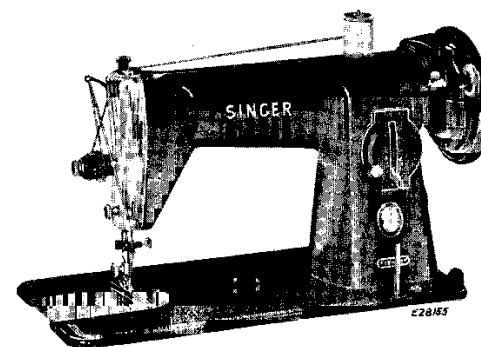

MACHINE NO. 15-75

No.	PLATE	NAME
*171537	----	ARM WITH 435AL, 15498, 81110, 125331, 125334, TRADE MARK, NUMBER PLATE, AND FOUR 140543L.....
		NOTE: WHEN ORDERING No. 171537, COLOR REQUIRED MUST BE SPECIFIED.
*171538	----	ARM AND BED ASSEMBLY WITH 125255, 171537, TWO 2002 AND THREE 138E....
		NOTE: WHEN ORDERING No. 171538, COLOR REQUIRED MUST BE SPECIFIED.
2002	26106	ARM DOWEL PIN (2).....
125331	26106	ARM OIL PAD (FELT) FOR OILING ARM SHAFT BACK BEARING.....
81110	26106	ARM OIL PAD SPRING.....
125334	26106	ARM OIL PAD SPRING CAP.....
138E	26106	ARM SCREW (3).....
125253	26106	ARM SHAFT.....
125254	----	ARM SHAFT 125253 WITH 15434, 15498 AND 125045.....
15498	26106	ARM SHAFT BUSHING.....
435AL	26106	ARM SHAFT BUSHING SET SCREW.....
125466	26001	ARM SIDE COVER.....
		NOTE: WHEN ORDERING No. 125466, COLOR REQUIRED MUST BE SPECIFIED.
51224ZB	26001	ARM SIDE COVER THUMB SCREW.....
2007ZG	26107	ARM SPOOL PIN.....
8879	26107	ARM SPOOL PIN WASHER.....
*125255	----	BED.....
256ZB	26106	CLAMP STOP MOTION CLAMP SCREW.....
248ZA	26106	CLAMP STOP MOTION CLAMP STOP SCREW...
171502	26106	CLAMP STOP MOTION CLAMP WASHER.....
15312	----	CLAMP STOP MOTION FLANGED BUSHING....
15313	26106	CLAMP STOP MOTION FLANGED BUSHING 15312 WITH TWO 462AL.....

No.	PLATE	NAME
462AL	26106	CLAMP STOP MOTION FLANGE BUSHING SET SCREW (2).....
15314	-----	CLAMP STOP MOTION COMPLETE, Nos. 248ZA, 256ZB, 15313 AND 171502...
125021	26106	CRANK CONNECTING ROD WITH 125044 AND TWO 896AL.....
896AL	26106	CRANK CONNECTING ROD CAP SCREW (2)..
375C	26106	CRANK CONNECTING ROD HINGE SCREW....
1518R	26106	CRANK CONNECTING ROD HINGE SCREW NUT
125044	26106	CRANK CONNECTING ROD OIL PAD (FELT).
125467	26107	FACE PLATE WITH 15410, 125258 AND 125472.....
125468	26107	FACE PLATE 125467 WITH 857ZB, 50292ZB AND 125317.....
125469	26107	FACE PLATE COMPLETE, Nos. 125418 AND 125468.....
125470	-----	FACE PLATE THREAD GUARD.....
125472	26107	FACE PLATE THREAD GUARD 125470 WITH 125373.....
125373	-----	FACE PLATE THREAD GUARD RIVET.....
51224ZB	26107	FACE PLATE THUMB SCREW (LOWER).....
51354J	26107	FACE PLATE THUMB SCREW (UPPER).....
2835	26103	FEED BAR.....
315C	26103	FEED BAR SCREW CENTER (2).....
15445	-----	FEED BAR SCREW CENTER 315C WITH 1519R (2).....
1519R	26103	FEED BAR SCREW CENTER NUT (2).....
125386	26103	FEED BAR THROW-OUT LEVER WITH 1813..
125349	26103	FEED BAR THROW-OUT LEVER RETAINING RING.....
1904	26103	FEED BAR THROW-OUT LEVER ROLLER.....
1813	-----	FEED BAR THROW-OUT LEVER ROLLER AND STUD, Nos. 1904 AND 125060.....
125060	-----	FEED BAR THROW-OUT LEVER ROLLER STUD
125387	-----	FEED BAR THROW-OUT LEVER SPRING.....
51289X	26103	FEED BAR THROW-OUT LEVER THUMB SCREW
125045	26106	FEED CAM AND COUNTERBALANCE WITH 1285AL.....
1285AL	26106	FEED CAM AND COUNTERBALANCE POSITION SCREW.....
125261	26102	FEED DOG, 12 TEETH (14 TEETH TO THE INCH).....
208AL	26102	FEED DOG SCREW (2).....
125262	26106	FEED FORKED CONNECTION WITH 175R....
125340	-----	FEED FORKED CONNECTION 125262 WITH 125335.....
175R	26106	FEED FORKED CONNECTION ADJUSTING SCREW.....
1381C	26106	FEED FORKED CONNECTION HINGE SCREW (ECCENTRIC).....
1520R	26106	FEED FORKED CONNECTION HINGE SCREW NUT.....
125047	26106	FEED FORKED CONNECTION SLIDE BLOCK..
125335	-----	FEED FORKED CONNECTION SLIDE BLOCK 125047 WITH 1085E.....
1085E	26106	FEED FORKED CONNECTION SLIDE BLOCK SCREW STUD.....
125263	26103	FEED LIFTING ROCK SHAFT.....
125388	26103	FEED LIFTING ROCK SHAFT CRANK WITH 157R.....
157R	26103	FEED LIFTING ROCK SHAFT CRANK CLAMPING SCREW.....

No.	PLATE	NAME
125389	-----	FEED LIFTING ROCK SHAFT CRANK COMPLETE, Nos. 51289X, 125386, 125387 AND 125388.....
125390	-----	FEED LIFTING ROCK SHAFT COMPLETE, Nos. 125263, 125349 AND 125389...
304C	26103	FEED LIFTING ROCK SHAFT SCREW CENTER (2).....
125344	-----	FEED LIFTING ROCK SHAFT SCREW CENTER 304C WITH 1513R (2).....
1513R	26103	FEED LIFTING ROCK SHAFT SCREW CENTER NUT (2).....
125397	26106	FEED REGULATOR.....
125398	-----	FEED REGULATOR 125397 WITH 125381...
50353E	26106	FEED REGULATOR HINGE SCREW.....
125399	26106	FEED REGULATOR HINGE SCREW FRICTION WASHER.....
45305	26001	FEED REVERSING HANDLE.....
125381	-----	FEED REVERSING HANDLE 45305 WITH 1550R.....
1550R	26001	FEED REVERSING HANDLE LOCK NUT.....
125270	26103	FEED ROCK SHAFT.....
304C	26103	FEED ROCK SHAFT SCREW CENTER (2)....
125344	-----	FEED ROCK SHAFT SCREW CENTER 304C WITH 1513R (2).....
1513R	26103	FEED ROCK SHAFT SCREW CENTER NUT (2)
125473	26106	HAND WHEEL (DISC) 2-1/4 IN. PULLEY..
		NOTE: WHEN ORDERING No. 125473, COLOR REQUIRED MUST BE SPECIFIED.
51045AL	26106	MACHINE HINGE CONNECTION SET SCREW (2).....
125377	26104	NEEDLE BAR.....
125273	26104	NEEDLE BAR BUSHING WITH 125274.....
125274	26104	NEEDLE BAR BUSHING OIL PAD (FELT)...
1498AL	26104	NEEDLE BAR BUSHING SET SCREW.....
15248	26104	NEEDLE BAR CONNECTING LINK WITH 51002E.....
125275	-----	NEEDLE BAR CONNECTING LINK 15248 WITH 125276.....
51002E	26104	NEEDLE BAR CONNECTING LINK ADJUSTING SCREW.....
570C	26106	NEEDLE BAR CONNECTING LINK HINGE SCREW.....
1520R	26106	NEEDLE BAR CONNECTING LINK HINGE SCREW NUT.....
125276	26104	NEEDLE BAR CONNECTING STUD WITH 1341AL.....
1341AL	26104	NEEDLE BAR CONNECTING STUD SET SCREW
45334	26104	NEEDLE CLAMP BODY WITH 140545ZC.....
45285	-----	NEEDLE CLAMP BODY 45334 WITH 51308ZJ
125378	26104	NEEDLE CLAMP GIB AND THREAD GUARD...
51308ZJ	26104	NEEDLE CLAMP POSITION SCREW.....
140545ZC	26104	NEEDLE CLAMP THUMB SCREW.....
	-----	NUMBER PLATE.....
140543L	-----	NUMBER PLATE DRIVE SCREW (2).....
125280	26103	OSCILLATING ROCK SHAFT WITH 125056..
125048	26103	OSCILLATING ROCK SHAFT CENTER (LEFT)
51246AL	26103	OSCILLATING ROCK SHAFT CENTER (LEFT) SET SCREW.....
125049	26103	OSCILLATING ROCK SHAFT CENTER (RIGHT)
51246AL	26103	OSCILLATING ROCK SHAFT CENTER (RIGHT) SET SCREW.....
125056	26103	OSCILLATING ROCK SHAFT OIL WICK (BRAIDED COTTON).....

No.	PLATE	NAME
125500	26103	OSCILLATING SHAFT.....
125284	26103	OSCILLATING SHAFT CRANK WITH 125330 AND TWO 462AL.....
462AL	26103	OSCILLATING SHAFT CRANK SET SCREW (2)
125330	26103	OSCILLATING SHAFT CRANK SLIDE BLOCK..
125061	26104	PRESSER BAR.....
125474	26104	PRESSER BAR LIFTER.....
15486	26104	PRESSER BAR LIFTER HINGE STUD.....
140712AL	26104	PRESSER BAR LIFTER HINGE STUD SET SCREW.....
80011	26104	PRESSER BAR SPRING.....
2068	26104	PRESSER BAR SPRING BRACKET WITH 453AL
453AL	26104	PRESSER BAR SPRING BRACKET SET SCREW.
2070	26104	PRESSER BAR SPRING WASHER.....
45321	26102	PRESSER FOOT (HINGED).....
51224ZB	26102	PRESSER FOOT THUMB SCREW.....
51228ZJ	26104	PRESSURE REGULATING THUMB SCREW.....
66773	-----	PRESSURE REGULATING THUMB SCREW 51228ZJ WITH 66752.....
66752	26104	PRESSURE REGULATING THUMB SCREW PLUG (FELT WICK).....
125453	26105	SHUTTLE BOBBIN.....
125297	26105	SHUTTLE BOBBIN CASE LATCH.....
125320	26105	SHUTTLE BOBBIN CASE LATCH LEVER.....
2974	26105	SHUTTLE BOBBIN CASE LATCH LEVER FULCRUM PIN.....
2975	26105	SHUTTLE BOBBIN CASE LATCH SPRING.....
592E	26105	SHUTTLE BOBBIN CASE LATCH STOP SCREW.
125288	26105	SHUTTLE BOBBIN CASE HINGE, Nos. 2974, 125287 AND 125320.....
125290	26105	SHUTTLE BOBBIN CASE POSITION PLATE.....
391R	26105	SHUTTLE BOBBIN CASE POSITION PLATE SCREW (2).....
125291	26105	SHUTTLE BOBBIN CASE COMPLETE, Nos. 591F, 592E, 2975, 125288 AND 125293.....
125292	26105	SHUTTLE BODY.....
591F	26105	SHUTTLE TENSION REGULATING SCREW.....
125293	26105	SHUTTLE TENSION SPRING.....
125294	26105	SHUTTLE 1-11/16 IN. DIAM., Nos. 125291, 125292 AND 125453.....
125297	26103	SHUTTLE DRIVER WITH TWO 1253AL.....
125322	-----	SHUTTLE DRIVER, 125297 WITH 125298 AND TWO 51229E.....
125298	26103	SHUTTLE DRIVER CUSHION SPRING.....
51229E	26103	SHUTTLE DRIVER CUSHION SPRING SCREW (2).....
1253AL	26103	SHUTTLE DRIVER SET SCREW (2).....
125299	26105	SHUTTLE RACE BACK.....
125301	26105	SHUTTLE RACE BACK POSITION PIN (2).....
125302	26105	SHUTTLE RACE BACK SPRING.....
51261R	26105	SHUTTLE RACE BACK SPRING THUMB SCREW.
125303	26105	SHUTTLE RACE BODY.....
125304	-----	SHUTTLE RACE BODY 125303 WITH 125305 AND TWO 662R.....
125300	-----	SHUTTLE RACE BODY 125304 WITH 125290 AND TWO EACH 391R AND 125301.....
125305	26105	SHUTTLE RACE CAP.....
662R	26105	SHUTTLE RACE CAP SCREW (2).....
125306	26105	SHUTTLE RACE COMPLETE, Nos. 51261R, 125299, 125300 AND 125302.....
145J	26105	SHUTTLE RACE SCREW (2).....

No.	PLATE	NAME
125337	26102	SHUTTLE RACE SLIDE SPRING.....
51282ZJ	26102	SHUTTLE RACE SLIDE SPRING SCREW (2)..
125338BA	26102	SHUTTLE RACE SLIDE WITH 125337 AND TWO 51282ZJ.....
125475	26001	STITCH INDICATOR PLATE.....
		NOTE: WHEN ORDERING No. 125475, COLOR RE- QUIRED MUST BE SPECIFIED.
335ZB	26001	STITCH INDICATOR PLATE SCREW (2).....
125481	26001	STITCH REGULATING PLATE.....
125479	-----	STITCH REGULATING PLATE 125481 WITH 45310, 51312ZB, 125400 AND 125475. NOTE: WHEN ORDERING No. 125479, COLOR RE- QUIRED MUST BE SPECIFIED.
51312ZB	26001	STITCH REGULATING THUMB SCREW.....
45310	26001	STITCH REGULATING THUMB SCREW WASHER (FIBER).....
125400	26001	STITCH REGULATING THUMB SCREW FRICTION WASHER.....
2102	26107	TENSION DISC (2).....
125421AH	26107	TENSION INDICATOR.....
		NOTE: WHEN ORDERING No. 125421, COLOR RE- QUIRED MUST BE SPECIFIED.
125416AH	26107	TENSION INDICATOR FLANGE.....
		NOTE: WHEN ORDERING No. 125416, COLOR RE- QUIRED MUST BE SPECIFIED.
45865	26107	TENSION INDICATOR FLANGE STOP WASHER.
51682ZB	26107	TENSION REGULATING THUMB NUT WITH 45339.....
45339	26107	TENSION REGULATING THUMB NUT ENGAGING PIN.....
125417	26107	TENSION RELEASING PIN.....
125314	26107	TENSION SPRING.....
140175ZJ	26107	TENSION STUD.....
125420	-----	TENSION STUD 140175ZJ WITH 51682ZB...
15410	26107	TENSION STUD BUSHING.....
50292ZB	26107	TENSION STUD SET SCREW.....
125418AH	26107	TENSION (GRADUATED) COMPLETE, Nos. 45865, 125314, 125316, 125416, 125417, 125419, 125420, 125421 AND TWO 2102.....
		NOTE: WHEN ORDERING No. 125418, COLOR RE- QUIRED MUST BE SPECIFIED.
26075	26104	THREAD CUTTER AND HOLDER.....
15272	26106	THREAD TAKE-UP CAM WITH 140511AL.....
15434	-----	THREAD TAKE-UP CAM 15272 WITH 570C AND 1520R.....
140511AL	26106	THREAD TAKE-UP CAM POSITION SCREW.....
*125382	26106	THREAD TAKE-UP LEVER WITH 1822.....
125383	-----	THREAD TAKE-UP LEVER 125382 WITH 50527C.....
50527C	26106	THREAD TAKE-UP LEVER HINGE SCREW.....
1822	26106	THREAD TAKE-UP LEVER ROLLER AND STUD.
125316	26107	THREAD TAKE-UP SPRING.....
125317	26107	THREAD TAKE-UP SPRING REGULATOR.....
857ZB	26107	THREAD TAKE-UP SPRING REGULATOR SET SCREW.....
125419	26107	THREAD TAKE-UP SPRING THREAD GUARD AND TENSION THREAD GUIDE.....
173585	26102	THROAT PLATE FOR 125261.....
		NOTE: WHEN ORDERING No. 173585, STATE FINISH REQUIRED.
691BB	26102	THROAT PLATE SCREW (2).....
-----	-----	TRADE MARK.....
140543L	-----	TRADE MARK DRIVE SCREW (2).....

**ACCESSORIES**

No.	PLATE	NAME
2007ZG	-----	ARM SPOOL PIN.....
120855	26016	HEMMER (FOOT).....
125453	26105	BOBBIN (4).....

**BOBBIN WINDER**

No.	PLATE	NAME
15072	26009	BOBBIN POSITION PIN.....
125476	26009	BRACKET (BELT COVER).....
		NOTE: WHEN ORDERING No. 125476, COLOR RE- QUIRED MUST BE SPECIFIED.
158R	26009	BRACKET SCREW (2).....
66670	26009	FRAME.....
		NOTE: WHEN ORDERING No. 66670, COLOR RE- QUIRED MUST BE SPECIFIED.
125366	26009	FRAME 66670 WITH 15288 AND 125068....
		NOTE: WHEN ORDERING No. 125366, COLOR RE- QUIRED MUST BE SPECIFIED.
51319ZJ	26009	FRAME HINGE SCREW.....
66601	26009	FRAME SPRING.....
15287	26009	FRICTION RING (RUBBER).....
		NOTE: WHEN ORDERING No. 15287, COLOR RE- QUIRED MUST BE SPECIFIED.
15288	26009	PULLEY.....
125068	26009	SPINDLE WITH 15072.....
8879	26107	SPOOL PIN WASHER.....
		NOTE: WHEN ORDERING No. 8879, COLOR RE- QUIRED MUST BE SPECIFIED.
125376	26009	STOP LATCH.....
51303ZJ	26009	STOP LATCH HINGE SCREW.....
125462	26009	STOP LATCH SPRING.....
125395	26009	TENSION BRACKET.....
125396	26009	TENSION BRACKET COMPLETE, Nos. 45847, 45915, 45916, 125395 AND 140138ZB.
193ZB	26009	TENSION BRACKET SCREW.....
45915	26009	TENSION DISC.....
45916	26009	TENSION DISC SCREW WASHER.....
45847	26009	TENSION DISC SPRING.....
140138ZB	26009	TENSION SCREW.....
125326	26009	TRIPPING ARM.....
190ZB	26009	TRIPPING ARM SCREW.....
125478	26009	BOBBIN WINDER COMPLETE, Nos. 190ZB, 15287, 51303ZJ, 51319ZJ, 66601, 125326, 125366, 125376, 125462 AND 125476.....
		NOTE: WHEN ORDERING No. 125478, COLOR RE- QUIRED MUST BE SPECIFIED.

**BIAS GAUGE**

No.	PLATE	NAME
25525	-----	BIAS GAUGE.....

**BRAIDER**

No.	PLATE	NAME
25510	26016	BRAIDER.....
289B	26016	BRAIDER THUMB SCREW.....

**FELLER (Foot)**

No.	PLATE	NAME
120914	26016	FELLER (FOOT).....

**FINGER GUARD**

No.	PLATE	NAME
121725	26017	FINGER GUARD.....

**HEMMER (Foot)**

No.	PLATE	NAME
120962	26016	HEMMER (FOOT) FOR 1/8 IN. HEM.....
25893	26016	HEMMER (FOOT) FOR 1/4 IN. HEM.....

**HEMSTITCHER**

No.	PLATE	NAME
120687	26016	HEMSTITCHER WITH YIELDING PRESSER PLATE.....

**PRESSER FEET**

No.	PLATE	NAME
36058	26016	PRESSER FOOT WITH 665B AND 36059, FOR BLIND STITCH CORDING, TO TURN SMALL CURVES.....
		NOTE: WHEN ORDERING No. 36058, SEND SAMPLE OF CORD FOR WHICH IT IS TO BE USED.
36059	26016	PRESSER FOOT CORD GUIDE.....
		NOTE: WHEN ORDERING No. 36059, SEND SAMPLE OF CORD, FOR WHICH IT IS TO BE USED.



## PRESSER FEET

No.	PLATE	NAME
665B	26016	PRESSER FOOT CORD GUIDE SCREW.....
36067	26016	PRESSER FOOT, FOR BRAIDING, FOR ART WORK, FOR BRAID 1/16 IN. TO 3/16 IN. WIDE.....
NOTE: WHEN ORDERING No. 36067, STATE THE SIZE OR SEND SAMPLE OF BRAID FOR WHICH IT IS TO BE USED.		
25978	26016	PRESSER FOOT (SINGLE TOE) FOR GATHERING.....

PRESSER FOOT WITH GRADUATED  
ADJUSTABLE GUIDES

No.	PLATE	NAME
121717	26017	PRESSER FOOT WITH 337D, 35002, 35135, 35206 AND 36696.....
35002	26017	PRESSER FOOT EXTENSION.....
35003	26017	PRESSER FOOT GRADUATED ADJUSTABLE GUIDE (LONG, LEFT).....
35004	26017	PRESSER FOOT GRADUATED ADJUSTABLE GUIDE (LONG, RIGHT).....
35005	26017	PRESSER FOOT GRADUATED ADJUSTABLE GUIDE (SHORT, RIGHT).....
35006	26017	PRESSER FOOT GRADUATED ADJUSTABLE GUIDE (SHORT, RIGHT) FLUSH.....
35135	26017	PRESSER FOOT GRADUATED ADJUSTABLE GUIDE CLAMP.....
35206	26017	PRESSER FOOT GRADUATED ADJUSTABLE GUIDE CLAMP LEVER.....
337D	26017	PRESSER FOOT GRADUATED ADJUSTABLE GUIDE CLAMP SCREW.....
36696	26017	PRESSER FOOT GRADUATED ADJUSTABLE GUIDE CLAMP STEADY PIN.....
121718	26017	PRESSER FOOT WITH EXTENSION AND GRADUATED ADJUSTABLE GUIDE COM- PLETE, Nos. 35003, 35004, 35005, 35006 AND 121717.....

## QUILTER

No.	PLATE	NAME
35932	26017	QUILTER.....

RUFFLER SHIRRING PLATE  
(Universal)

No.	PLATE	NAME
121170	26017	RUFFLER SHIRRING PLATE (UNIVERSAL) WITH 51395W.....
51395W	26017	RUFFLER SHIRRING PLATE THUMB SCREW...

## SEAM GUIDE

No.	PLATE	NAME
25527	26017	SEAM GUIDE.....
50053ZB	26017	SEAM GUIDE THUMB SCREW.....

## STILETTO

No.	PLATE	NAME
25539	----	STILETTO.....

## UNDER BRAIDER

No.	PLATE	NAME
160927	26017	UNDER BRAIDER WITH 51395W.....
51395W	26017	UNDER BRAIDER THUMB SCREW.....

SET OF ATTACHMENTS NO. 160809  
(U.S.A. and Canada only - with needles)

No.	PLATE	NAME
160359	26015	BINDER.....
36865	26015	EDGE STITCHER.....
121441	26015	GATHERING FOOT (DOUBLE TOE).....
35931	26015	HEMMER (ADJUSTABLE).....
15x1	----	NEEDLES (3 EACH, SIZES 11 AND 14) (6)
120598	26015	RUFFLER.....
25537	26015	SCREW DRIVER (MACHINE).....
120378	26015	SCREW DRIVER (SHUTTLE TENSION).....
161133	26015	TUBE OF OIL.....
160809	26015	SET OF ATTACHMENTS (WITH NEEDLES) COMPLETE, Nos. 25537, 35931, 36865, 120378, 120598, 121441, 160359, 161133, TWO 8879 AND SIX NEEDLES (15x1 THREE EACH SIZES 11 AND 14).....

SET OF ATTACHMENTS NO. 160810  
(All Countries except U.S.A., Canada and Brazil with needles)

No.	PLATE	NAME
121464	26015	BINDER.....
36865	26015	EDGE STITCHER.....
121441	26015	GATHERING FOOT (DOUBLE TOE).....
35931	26015	HEMMER (ADJUSTABLE).....
15x1	----	NEEDLES (3 EACH, SIZES 11 AND 14) (6)
120598	26015	RUFFLER.....
25537	26015	SCREW DRIVER (MACHINE).....
120378	26015	SCREW DRIVER (SHUTTLE TENSION).....
160810	----	SET OF ATTACHMENTS (WITH NEEDLES) COMPLETE, Nos. 25537, 35931, 36865, 120378, 120598, 121441, 121464, TWO 8879 AND SIX NEEDLES (15x1, THREE EACH OF SIZES 11 AND 14).....

**SET OF ATTACHMENTS NO. 160811**  
(Brazil only - less needles)

No.	PLATE	NAME
121464	26015	BINDER.....
36865	26015	EDGE STITCHER.....
121441	26015	GATHERING FOOT (DOUBLE TOE).....
35931	26015	HEMMER (ADJUSTABLE).....
120598	26015	RUFFLER.....
25537	26015	SCREW DRIVER (MACHINE).....
120378	26015	SCREW DRIVER (SHUTTLE TENSION).....
160811	-----	SET OF ATTACHMENTS (LESS NEEDLES) COMPLETE, Nos. 25537, 35931, 36865, 120378, 120598, 121441, 121464 AND TWO 8879.....

**SPECIAL ATTACHMENTS**

No.	PLATE	NAME
161102	-----	AUTOMATIC ZIGZAGGER ATTACHMENT.....
160506	-----	BUTTONHOLER.....
35505	-----	EMBROIDERY ATTACHMENT FOR TWO THREADS
26538	-----	STYLE-O-MATIC ATTACHMENT.....
121634	-----	NEEDLE THREADER AND SEAM RIPPER.....
35985	-----	TUBULAR TRIMMING ATTACHMENT.....
160858	-----	DARNING ATTACHMENT (STRIPPER FOOT)...
160719	-----	DARNING AND EMBROIDERY ATTACHMENT....
160741	-----	WALKING PRESSER FOOT.....
161127	-----	ZIPPER FOOT (LEFT OR RIGHT) ADJUST- ABLE, HINGED.....

**NUMERICAL LIST OF PARTS**

No.	PLATE	NAME
138E	26106	ARM SCREW, FOR 171538.....
145J	26105	SHUTTLE RACE SCREW.....
157R	26103	FEED LIFTING ROCK SHAFT CRANK CLAMP- ING SCREW, FOR 125388.....
158R	26009	BOBBIN WINDER BRACKET SCREW.....
175R	26106	FEED FORKED CONNECTION ADJUSTING SCREW, FOR 125262.....
190ZB	26009	BOBBIN WINDER TRIPPING ARM SCREW, FOR 125478.....
193ZB	26009	BOBBIN WINDER TENSION BRACKET SCREW..
208AL	26102	FEED DOG SCREW.....
248ZA	26106	CLAMP STOP MOTION CLAMP STOP SCREW, FOR 15314.....
256ZB	26106	CLAMP STOP MOTION CLAMP SCREW, FOR 15314.....
289B	26016	BRAIDER THUMB SCREW.....
304C	26103	FEED LIFTING ROCK SHAFT SCREW CENTER, FOR 125344.....
304C	26103	FEED ROCK SHAFT SCREW CENTER, FOR 125344.....
315C	26103	FEED BAR SCREW CENTER, FOR 15445.....
335ZB	26001	STITCH INDICATOR PLATE SCREW.....
337D	26Q17	PRESSER FOOT GRADUATED ADJUSTABLE GUIDE CLAMP SCREW, FOR 121717.....
375C	26106	CRANK CONNECTING ROD HINGE SCREW.....
391R	26105	SHUTTLE BOBBIN CASE POSITION PLATE SCREW, FOR 125300.....
435AL	26106	ARM SHAFT BUSHING SET SCREW, FOR 171537.....
453AL	26104	PRESSER BAR SPRING BRACKET SET SCREW, FOR 2068.....
462AL	26106	CLAMP STOP MOTION FLANGED BUSHING SET SCREW, FOR 15313.....
462AL	26103	OSCILLATING SHAFT CRANK SET SCREW, FOR 125284.....
570C	26106	NEEDLE BAR CONNECTING LINK HINGE SCREW, FOR 15434.....
591F	26105	SHUTTLE TENSION REGULATING SCREW, FOR 125291.....
592E	26105	SHUTTLE BOBBIN CASE LATCH STOP SCREW, FOR 125291.....
662R	26105	SHUTTLE RACE CAP SCREW, FOR 125304...
665B	26016	PRESSER FOOT CORD GUIDE SCREW, FOR 36058.....
691BB	26102	THROAT PLATE SCREW.....
857ZB	26107	THREAD TAKE-UP SPRING REGULATOR SET SCREW, FOR 125468.....
896AL	26106	CRANK CONNECTING ROD CAP SCREW, FOR 125021.....
1085E	26106	FEED FORKED CONNECTION SLIDE BLACK SCREW STUD, FOR 125335.....
1253AL	26103	SHUTTLE DRIVER SET SCREW, FOR 125297.
1285AL	26102	FEED CAM AND COUNTERBALANCE POSITION SCREW, FOR 125045.....
1341AL	26104	NEEDLE BAR CONNECTING STUD SET SCREW, FOR 125276.....
1381C	26106	FEED FORKED CONNECTION HINGE SCREW (ECCENTRIC).....
1498AL	26104	NEEDLE BAR BUSHING SET SCREW.....

## NUMERICAL LIST OF PARTS

No.	PLATE	NAME
1513R	26103	FEED LIFTING ROCK SHAFT SCREW CENTER NUT, FOR 125344.....
1513R	26103	FEED ROCK SHAFT SCREW CENTER NUT, FOR 125344.....
1518R	26106	CRANK CONNECTING ROD HINGE SCREW NUT.
1519R	26103	FEED BAR SCREW CENTER NUT, FOR 15445.
1520R	26106	FEED FORKED CONNECTION HINGE SCREW NUT.....
1520R	26106	NEEDLE BAR CONNECTING LINK HINGE SCREW NUT, FOR 15434.....
1550R	26001	FEED REVERSING HANDLE LOCK NUT, FOR 125381.....
1813	-----	FEED BAR THROW-OUT LEVER ROLLER AND STUD, Nos. 1904 AND 125060, FOR 125386.....
1822	26106	THREAD TAKE-UP LEVER ROLLER AND STUD, FOR 125382.....
1904	26103	FEED BAR THROW-OUT LEVER ROLLER, FOR 1813.....
2002	26106	ARM DOWEL PIN, FOR 171538.....
20072G	26107	ARM SPOOL PIN.....
2068	26104	PRESSER BAR SPRING BRACKET WITH 453AL
2070	26104	PRESSER BAR SPRING WASHER.....
2102	26107	TENSION DISC FOR 125418.....
2835	26103	FEED BAR.....
2974	26105	SHUTTLE BOBBIN CASE LATCH LEVER FULCRUM PIN, FOR 125288.....
2975	26105	SHUTTLE BOBBIN CASE LATCH SPRING, FOR 125291.....
8879	26107	ARM SPOOL PIN WASHER, FOR 160809, 160810 AND 160811.....
		NOTE: WHEN ORDERING No. 8879, COLOR REQUIRED MUST BE SPECIFIED.
8879	26107	BOBBIN WINDER SPOOL PIN WASHER, FOR 160809, 160810 AND 160811.....
		NOTE: WHEN ORDERING No. 8879, COLOR REQUIRED MUST BE SPECIFIED.
15072	26009	BOBBIN WINDER BOBBIN POSITION PIN, FOR 125068.....
15248	26104	NEEDLE BAR CONNECTING LINK WITH 51002E, FOR 125275.....
15272	26106	THREAD TAKE-UP CAM WITH 140511AL, FOR 15434.....
15287	26009	BOBBIN WINDER FRICTION RING (RUBBER) FOR 125478.....
		NOTE: WHEN ORDERING No. 15287, COLOR REQUIRED MUST BE SPECIFIED.
15288	26009	BOBBIN WINDER PULLEY, FOR 125366.....
15312	-----	CLAMP STOP MOTION FLANGED BUSHING, FOR 15313.....
15313	26106	CLAMP STOP MOTION FLANGED BUSHING 15312 WITH TWO 462AL, FOR 15314....
15314	-----	CLAMP STOP MOTION COMPLETE, Nos. 248ZA, 256ZB, 15313 AND 171502....
15410	26107	TENSION STUD BUSHING, FOR 125467.....
15434	-----	THREAD TAKE-UP CAM 15272 WITH 570C AND 1520R, FOR 125254.....
15445	-----	FEED BAR SCREW CENTER 315C WITH 1519R
15486	26104	PRESSER BAR LIFTER HINGE STUD
15498	26106	ARM SHAFT BUSHING, FOR 125254 AND 171537.....
25510	26016	BRAIDER.....

## NUMERICAL LIST OF PARTS

No.	PLATE	NAME
25525	-----	BIAS GAUGE.....
25527	26017	SEAM GUIDE.....
25537	26015	SCREW DRIVER (MACHINE) FOR 160809, 160810 AND 160811.....
25539	-----	STILETTO.....
25893	26016	HEMMER FOOT FOR 1/4 IN. HEM.....
25978	26016	PRESSER FOOT (SINGLE TOE) FOR GATHERING.....
26075	26104	THREAD CUTTER AND HOLDER.....
26538	-----	STYLE-O-MATIC ATTACHMENT (SPECIAL ATTACHMENTS).....
35002	26017	PRESSER FOOT EXTENSION FOR 121717....
35003	26017	PRESSER FOOT GRADUATED ADJUSTABLE GUIDE (LONG, LEFT), FOR 121718....
35004	26017	PRESSER FOOT GRADUATED ADJUSTABLE GUIDE (LONG, RIGHT), FOR 121718....
35005	26017	PRESSER FOOT GRADUATED ADJUSTABLE GUIDE (SHORT, RIGHT), FOR 121718..
35006	26017	PRESSER FOOT GRADUATED ADJUSTABLE GUIDE (SHORT, RIGHT) FLUSH, FOR 121718.....
35135	26017	PRESSER FOOT GRADUATED ADJUSTABLE GUIDE CLAMP, FOR 121717.....
35206	26017	PRESSER FOOT GRADUATED ADJUSTABLE GUIDE CLAMP LEVER, FOR 121717.....
35505	-----	EMBROIDERY ATTACHMENT FOR TWO THREADS (SPECIAL ATTACHMENTS).....
35931	26015	HEMMER (ADJUSTABLE) FOR 160809, 160810 AND 160811.....
35932	26017	QUILTER.....
35985	-----	TUBULAR TRIMMING ATTACHMENT (SPECIAL ATTACHMENTS).....
36058	26016	PRESSER FOOT WITH 665B AND 36059 FOR BLIND STITCH CORDING TO TURN SMALL CURVES.....
		NOTE: WHEN ORDERING No. 36058, SEND SAMPLE OF CORD FOR WHICH IT IS TO BE USED.
36059	26016	PRESSER FOOT CORD GUIDE, FOR 36058... NOTE: WHEN ORDERING No. 36059, SEND SAMPLE OF CORD FOR WHICH IT IS TO BE USED.
36067	26016	PRESSER FOOT, FOR BRAIDING, FOR ART WORK, FOR BRAID 1/16 IN. TO 3/16 IN. WIDE.....
		NOTE: WHEN ORDERING No. 36067, STATE THE SIZE OR SEND SAMPLE OF BRAID FOR WHICH IT IS TO BE USED.
36696	26017	PRESSER FOOT GRADUATED ADJUSTABLE GUIDE CLAMP STEADY PIN, FOR 121717
36865	26015	EDGE STITCHER FOR 160809, 160810 AND 160811.....
45285	-----	NEEDLE CLAMP BODY 45334 WITH 513082J.
45305	26001	FEED REVERSING HANDLE, FOR 125381....
45310	26001	STITCH REGULATING THUMB SCREW WASHER (FIBER) FOR 125479.....
45321	26102	PRESSER FOOT (HINGED).....
45334	26104	NEEDLE CLAMP BODY WITH 140545ZC, FOR 45285.....
45339	26107	TENSION REGULATING THUMB NUT ENGAGING PIN, FOR 516822B.....
45847	26009	BOBBIN WINDER TENSION DISC SPRING, FOR 125396.....
45865	26107	TENSION INDICATOR FLANGE STOP WASHER, FOR 125418.....

## NUMERICAL LIST OF PARTS

No.	PLATE	NAME
45915	26009	BOBBIN WINDER TENSION DISC, FOR 125396.....
45916	26009	BOBBIN WINDER TENSION DISC SCREW WASHER, FOR 125396.....
50053ZB	26017	SEAM GUIDE THUMB SCREW.....
50292ZB	26107	TENSION STUD SET SCREW, FOR 125468...
50353E	26106	FEED REGULATOR HINGE SCREW.....
50527C	26106	THREAD TAKE-UP LEVER HINGE SCREW, FOR 125383.....
51002E	26104	NEEDLE BAR CONNECTING LINK ADJUSTING SCREW, FOR 15248.....
51045AL	26106	MACHINE HINGE CONNECTION SET SCREW...
51224ZB	26001	ARM SIDE COVER THUMB SCREW.....
51224ZB	26107	FACE PLATE THUMB SCREW (LOWER).....
51224ZB	26102	PRESSER FOOT THUMB SCREW.....
51228ZJ	26104	PRESSURE REGULATING THUMB SCREW, FOR 66773.....
51229E	26103	SHUTTLE DRIVER CUSHION SPRING SCREW, FOR 125322.....
51246AL	26103	OSCILLATING ROCK SHAFT CENTER (LEFT) SET SCREW.....
51246AL	26103	OSCILLATING ROCK SHAFT CENTER (RIGHT) SET SCREW.....
51261R	26105	SHUTTLE RACE BACK SPRING THUMB SCREW, FOR 125306.....
51282ZJ	26102	SHUTTLE RACE SLIDE SPRING SCREW, FOR 125338.....
51289X	26103	FEED BAR THROW-OUT LEVER THUMB SCREW, FOR 125389.....
51303ZJ	26009	BOBBIN WINDER STOP LATCH HINGE SCREW, FOR 125478.....
51308ZJ	26104	NEEDLE CLAMP POSITION SCREW, FOR 45285.....
51312ZB	26001	STITCH REGULATING THUMB SCREW, FOR 125479.....
51319ZJ	26009	BOBBIN WINDER FRAME HINGE SCREW, FOR 125478.....
51354J	26107	FACE PLATE THUMB SCREW (UPPER).....
51395W	26017	RUFFLER SHIRRING PLATE THUMB SCREW, FOR 121170.....
51395W	26017	UNDER BRAIDER THUMB SCREW, FOR 160927
51682ZB	26107	TENSION REGULATING THUMB NUT WITH 45339, FOR 125420.....
66601	26009	BOBBIN WINDER FRAME SPRING, FOR 125478.....
66670	26009	BOBBIN WINDER FRAME, FOR 125366.....
		NOTE: WHEN ORDERING No. 66670, COLOR REQUIRED MUST BE SPECIFIED.
66752	26104	PRESSURE REGULATING THUMB SCREW PLUG (FELT WICK), FOR 66773.....
66773	-----	PRESSURE REGULATING THUMB SCREW 51228ZJ WITH 66752.....
80011	26104	PRESSER BAR SPRING.....
81110	26106	ARM OIL PAD SPRING, FOR 171537.....
120378	26015	SCREW DRIVER (SHUTTLE TENSION), FOR 160809, 160810 AND 160811.....
120598	26015	RUFFLER FOR 160809, 160810 AND 160811
120687	26016	HEMSTITCHER WITH YIELDING PRESSER PLATE.....
120855	26016	HEMMER (FOOT) ACCESSORIES.....
120914	26016	FELLER (FOOT).....
120962	26016	HEMMER (FOOT) FOR 1/8 IN. HEM.....

## NUMERICAL LIST OF PARTS

No.	PLATE	NAME
121170	26017	RUFFLER SHIRRING PLATE (UNIVERSAL) WITH 51395W.....
121441	26015	GATHERING FOOT (DOUBLE TOE) FOR 160809, 160810 AND 160811.....
121464	26015	BINDER FOR 160810 AND 160811.....
121634	-----	NEEDLE THREADER AND SEAM RIPPER (SPECIAL ATTACHMENTS).....
121717	26017	PRESSER FOOT WITH 337D, 35002, 35135, 35206 AND 36696 FOR 121718.....
121718	26017	PRESSER FOOT WITH EXTENSION AND GRADUATED ADJUSTABLE GUIDE COMPLETE, Nos. 35003, 35004, 35005, 35006 AND 121717.....
121725	26017	FINGER GUARD.....
125021	26106	CRANK CONNECTING ROD WITH 125044 AND TWO 896AL.....
125044	26106	CRANK CONNECTING ROD OIL PAD (FELT) FOR 125021.....
125045	26106	FEED CAM AND COUNTERBALANCE WITH 1285AL, FOR 125254.....
125047	26106	FEED FORKED CONNECTION SLIDE BLOCK, FOR 125335.....
125048	26103	OSCILLATING ROCK SHAFT CENTER (LEFT)
125049	26103	OSCILLATING ROCK SHAFT CENTER (RIGHT)
125056	26103	OSCILLATING ROCK SHAFT OIL WICK (BRAIDED COTTON) FOR 125280.....
125060	-----	FEED BAR THROW-OUT LEVER ROLLER STUD, FOR 1813.....
125061	26104	PRESSER BAR.....
125068	26009	BOBBIN WINDER SPINDLE WITH 15072, FOR 125366.....
125253	26106	ARM SHAFT, FOR 125254.....
125254	-----	ARM SHAFT 125253 WITH 15434, 15498 AND 125045.....
*125255	-----	BED, FOR 171538.....
125261	26102	FEED DOG, 12 TEETH (14 TEETH TO THE INCH) FOR 173585.....
125262	26106	FEED FORKED CONNECTION WITH 175R FOR 125340.....
125263	26103	FEED LIFTING ROCK SHAFT, FOR 125390..
125270	26103	FEED ROCK SHAFT.....
125273	26104	NEEDLE BAR BUSHING WITH 125274.....
125274	26104	NEEDLE BAR BUSHING OIL PAD (FELT) FOR 125273.....
125275	-----	NEEDLE BAR CONNECTING LINK 15248 WITH 125276.....
125276	26104	NEEDLE BAR CONNECTING STUD WITH 1341AL, FOR 125275.....
125280	26103	OSCILLATING ROCK SHAFT WITH 125056...
125284	26103	OSCILLATING SHAFT CRANK WITH 125330 AND TWO 462AL.....
125287	26105	SHUTTLE BOBBIN CASE LATCH, FOR 125288
125288	26105	SHUTTLE BOBBIN CASE HINGE, Nos. 2974, 125287 AND 125320, FOR 125291.....
125290	26105	SHUTTLE BOBBIN CASE POSITION PLATE, FOR 125300.....
125291	26105	SHUTTLE BOBBIN CASE COMPLETE, FOR 125294, Nos. 591F, 592E, 2975, 125288 AND 125293.....
125292	26105	SHUTTLE BODY, FOR 125294.....
125293	26105	SHUTTLE TENSION SPRING, FOR 125291...
125294	26105	SHUTTLE 1-11/16 IN. DIAMETER, Nos. 125291, 125292 AND 125453.....

No.	PLATE	NAME
125297	26103	SHUTTLE DRIVER WITH TWO 1253AL, FOR 125322.....
125298	26103	SHUTTLE DRIVER CUSHION SPRING, FOR 125322.....
125299	26105	SHUTTLE RACE BACK, FOR 125306.....
125300	-----	SHUTTLE RACE BODY 125304 WITH 125290 AND TWO EACH 391R AND 125301, FOR 125306.....
125301	26105	SHUTTLE RACE BACK POSITION PIN, FOR 125300.....
125302	26105	SHUTTLE RACE BACK SPRING, FOR 125306.....
125303	26105	SHUTTLE RACE BODY, FOR 125304.....
125304	-----	SHUTTLE RACE BODY 125303 WITH 125305 AND TWO 662R, FOR 125300.....
125305	26105	SHUTTLE RACE CAP, FOR 125304.....
125306	26105	SHUTTLE RACE COMPLETE, Nos. 51261R, 125299, 125300 AND 125302.....
125314	26107	TENSION SPRING FOR 125418.....
125316	26107	THREAD TAKE-UP SPRING, FOR 125418.....
125317	26107	THREAD TAKE-UP SPRING REGULATOR, FOR 125468.....
125320	26105	SHUTTLE BOBBIN CASE LATCH LEVER, FOR 125288.....
125322	-----	SHUTTLE DRIVER, 125297 WITH 125298 AND TWO 51229E.....
125326	26009	BOBBIN WINDER TRIPPING ARM, FOR 125478.....
125330	26103	OSCILLATING SHAFT CRANK SLIDE BLOCK, FOR 125284.....
125331	26106	ARM OIL PAD (FELT) FOR OILING ARM SHAFT BACK BEARING, FOR 171537....
125334	26106	ARM OIL PAD SPRING CAP, FOR 171537....
125335	-----	FEED FORKED CONNECTION SLIDE BLOCK 125047 WITH 1085E, FOR 125340.....
125337	26102	SHUTTLE RACE SLIDE SPRING, FOR 125338
125338BA	26102	SHUTTLE RACE SLIDE WITH 125337 AND TWO 51282ZJ.....
125340	-----	FEED FORKED CONNECTION 125262 WITH 125335.....
125344	-----	FEED LIFTING ROCK SHAFT SCREW CENTER 304C WITH 1513R.....
125344	-----	FEED ROCK SHAFT SCREW CENTER 304C WITH 1513R.....
125349	26103	FEED BAR THROW-OUT LEVER RETAINING RING, FOR 125390.....
125366	26009	BOBBIN WINDER FRAME 66670 WITH 15288 AND 125068, FOR 125478.....
125373	-----	NOTE: WHEN ORDERING No. 125366, COLOR REQUIRED MUST BE SPECIFIED. FACE PLATE THREAD GUARD RIVET, FOR 125472.....
125376	26009	BOBBIN WINDER STOP LATCH, FOR 125478.
125377	26104	NEEDLE BAR.....
125378	26104	NEEDLE CLAMP GIB AND THREAD GUARD.....
125381	-----	FEED REVERSING HANDLE 45305 WITH 1550R, FOR 125398.....
*125382	26106	THREAD TAKE-UP LEVER WITH 1822, FOR 125383.....
125383	-----	THREAD TAKE-UP LEVER 125382 WITH 50527C.....
125386	26103	FEED BAR THROW-OUT LEVER WITH 1813, FOR 125389.....

No.	PLATE	NAME
125387	-----	FEED BAR THROW-OUT LEVER SPRING, FOR 125389.....
125388	26103	FEED LIFTING ROCK SHAFT CRANK WITH 157R, FOR 125389.....
125389	-----	FEED LIFTING ROCK SHAFT CRANK COMPLETE, FOR 125390, Nos. 51289X, 125386, 125387 AND 125388.....
125390	-----	FEED LIFTING ROCK SHAFT COMPLETE, Nos. 125263, 125349 AND 125389....
125395	26009	BOBBIN WINDER TENSION BRACKET, FOR 125396.....
125396	26009	BOBBIN WINDER TENSION BRACKET COMPLETE, Nos. 45847, 45915, 45916, 125395 AND 140138ZB.....
125397	26106	FEED REGULATOR FOR 125398.....
125398	-----	FEED REGULATOR 125397 WITH 125381....
125399	26106	FEED REGULATOR HINGE SCREW FRICTION WASHER.....
125400	26001	STITCH REGULATING THUMB SCREW FRICTION WASHER, FOR 125479.....
125416AH	26107	TENSION INDICATOR FLANGE, FOR 125418. NOTE: WHEN ORDERING No. 125416, COLOR REQUIRED MUST BE SPECIFIED.
125417	26107	TENSION RELEASING PIN, FOR 125418....
125418AH	26107	TENSION (GRADUATED) COMPLETE, FOR 125469, Nos. 45865, 125314, 125316, 125416, 125417, 125419, 125420, 125421 AND TWO 2102.....
125419	26107	NOTE: WHEN ORDERING No. 125418, COLOR REQUIRED MUST BE SPECIFIED. THREAD TAKE-UP SPRING THREAD GUARD AND TENSION THREAD GUIDE, FOR 125418.....
125420	-----	TENSION STUD, 140175ZJ WITH 51682ZB, FOR 125418.....
125421AH	26107	TENSION INDICATOR, FOR 125418..... NOTE: WHEN ORDERING No. 125421, COLOR REQUIRED MUST BE SPECIFIED.
125453	26105	SHUTTLE BOBBIN, FOR 125294.....
125462	26009	BOBBIN WINDER STOP LATCH SPRING, FOR 125478.....
125466	26001	ARM SIDE COVER..... NOTE: WHEN ORDERING No. 125466, COLOR REQUIRED MUST BE SPECIFIED.
125467	26107	FACE PLATE WITH 15410, 125258 AND 125472, FOR 125468.....
125468	26107	FACE PLATE 125467 WITH 857ZB, 50292ZB AND 125317, FOR 125469.....
125469	26107	FACE PLATE COMPLETE, Nos. 125418 AND 125468.....
125470	-----	FACE PLATE THREAD GUARD, FOR 125472..
125472	26107	FACE PLATE THREAD GUARD 125470 WITH 125373, FOR 125467.....
125473	26106	HAND WHEEL (DISC) 2-1/4 IN. PULLEY... NOTE: WHEN ORDERING No. 125473, COLOR REQUIRED MUST BE SPECIFIED.
125474	26104	PRESSER BAR LIFTER.....
125475	26001	STITCH INDICATOR PLATE, FOR 125479... NOTE: WHEN ORDERING No. 125475, COLOR REQUIRED MUST BE SPECIFIED.

## NUMERICAL LIST OF PARTS

No.	PLATE	NAME
125476	26009	BOBBIN WINDER BRACKET (BELT COVER) FOR 125478.....
		NOTE: WHEN ORDERING No. 125476, COLOR RE- QUIRED MUST BE SPECIFIED.
125478	26009	BOBBIN WINDER COMPLETE, Nos. 190ZB, 15287, 51303ZJ, 51319ZJ, 66601, 125326, 125366, 125376, 125462 AND 125476.....
		NOTE: WHEN ORDERING No. 125478, COLOR RE- QUIRED MUST BE SPECIFIED.
125479	-----	STITCH REGULATING PLATE 125481 WITH 45310, 51312ZB, 125400 AND 125475.
		NOTE: WHEN ORDERING No. 125479, COLOR RE- QUIRED MUST BE SPECIFIED.
125481	26001	STITCH REGULATING PLATE, FOR 125479..
125500	26103	OSCILLATING SHAFT.....
140138ZB	26009	BOBBIN WINDER TENSION SCREW, FOR 125396.....
140175ZJ	26107	TENSION STUD, FOR 125420.....
140511AL	26106	THREAD TAKE-UP CAM POSITION SCREW, FOR 15272.....
140543L	-----	NUMBER PLATE DRIVE SCREW, FOR 171537.
140543L	-----	TRADE MARK DRIVE SCREW, FOR 171537...
140545ZC	26104	NEEDLE CLAMP THUMB SCREW, FOR 45334..
140712AL	26104	PRESSER BAR LIFTER HINGE STUD SET SCREW.....
160359	26015	BINDER FOR 160809.....
160506	-----	BUTTONHOLER.....
160719	-----	DARNING AND EMBROIDERY ATTACHMENT (SPECIAL ATTACHMENTS).....
160741	-----	WALKING PRESSER FOOT (SPECIAL ATTACHMENTS).....
160809	26015	SET OF ATTACHMENTS (WITH NEEDLES) COMPLETE, (U.S.A. AND CANADA ONLY) Nos. 25537, 35931, 36865, 120378, 120598, 121441, 160359, 161133, TWO 8879 AND SIX NEEDLES (15x1 THREE EACH SIZES 11 AND 14).....
160810	-----	SET OF ATTACHMENTS (WITH NEEDLES) COMPLETE, (ALL COUNTRIES EXCEPT U.S.A., CANADA AND BRAZIL) Nos. 25537, 35931, 36865, 120378, 120598, 121441, 121464, TWO 8879 AND SIX NEEDLES (15x1 THREE EACH SIZES 11 AND 14).....
160811	-----	SET OF ATTACHMENTS (LESS NEEDLES) COMPLETE, (BRAZIL ONLY) Nos. 25537, 35931, 36865, 120378, 120598, 121441, 121464 AND TWO 8879.....
160858	-----	DARNING ATTACHMENT (STRIPPER FOOT) (SPECIAL ATTACHMENTS).....
160927	26017	UNDER BRAIDER WITH 51395W.....
161102	-----	AUTOMATIC ZIGZAGGER ATTACHMENT (SPECIAL ATTACHMENTS).....
161127	-----	ZIPPER FOOT (LEFT OR RIGHT) ADJUST- ABLE, HINGED (SPECIAL ATTACHMENTS)
161133	26015	TUBE OF OIL FOR 160809.....
171502	26106	CLAMP STOP MOTION CLAMP WASHER, FOR 15314.....
*171537	-----	ARM WITH 435AL, 15498, 81110, 125331, 125334, TRADE MARK, NUMBER PLATE, AND FOUR 140543L, FOR 171538.....
		NOTE: WHEN ORDERING No. 171537, COLOR RE- QUIRED MUST BE SPECIFIED.

## NUMERICAL LIST OF PARTS

No.	PLATE	NAME
*171538	-----	ARM AND BED ASSEMBLY, Nos. 125255, 171537, TWO 2002 AND THREE 138E...
		NOTE: WHEN ORDERING No. 171538, COLOR RE- QUIRED MUST BE SPECIFIED.
173585	26102	THROAT PLATE FOR 125261.....
		NOTE: WHEN ORDERING No. 173585, STATE FINISH REQUIRED.

26001-2/3

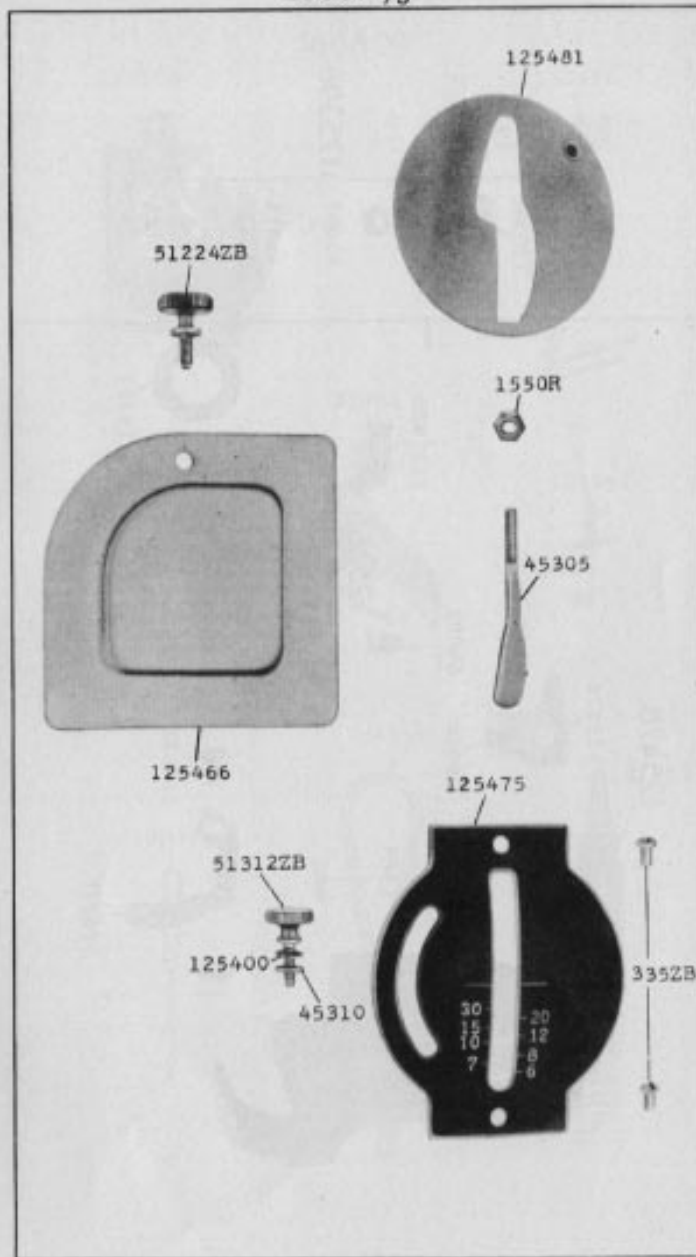

125478

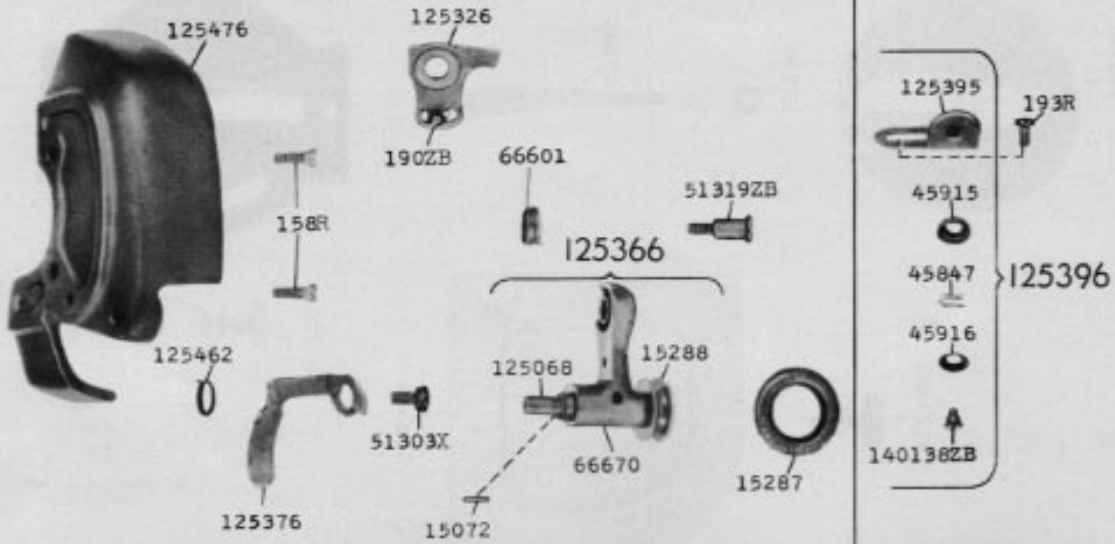

26009-1/2



26015-2/3

160809

120598



160359



35931



36865



121441



25537



120378



161133

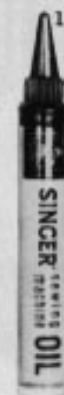

SINGER SEWING OIL

26016-2/3

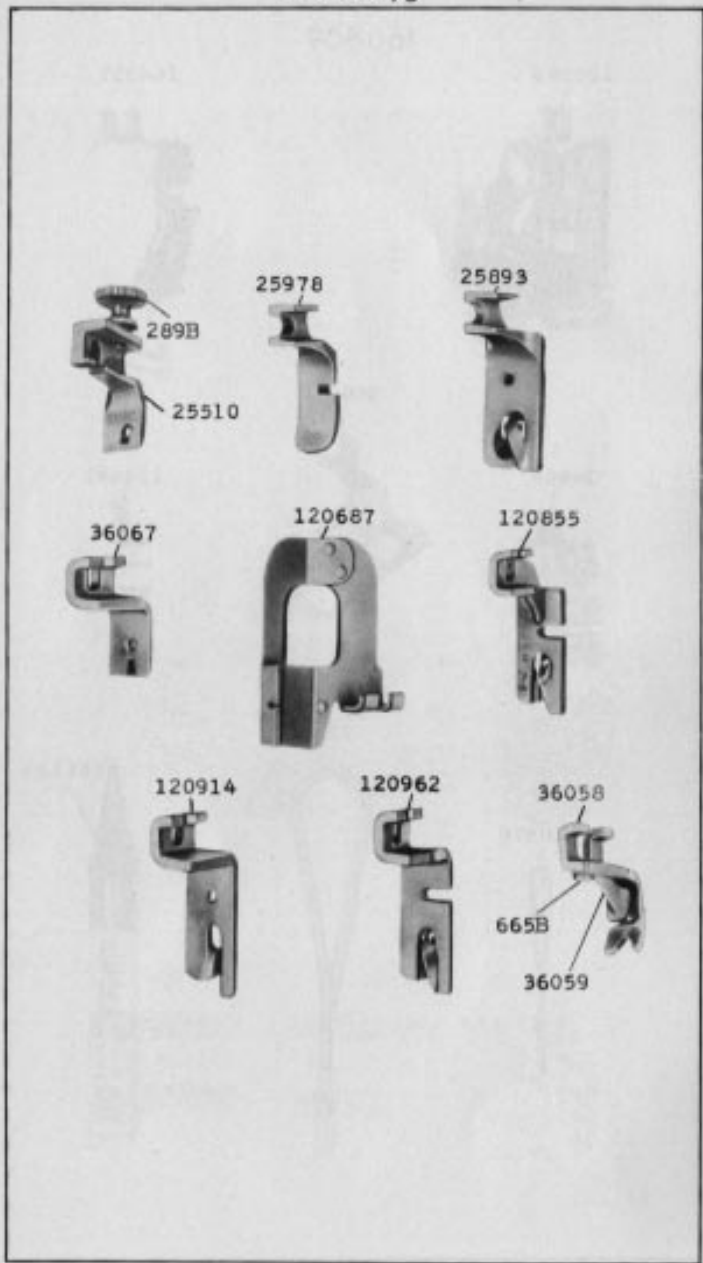

26017-2/3

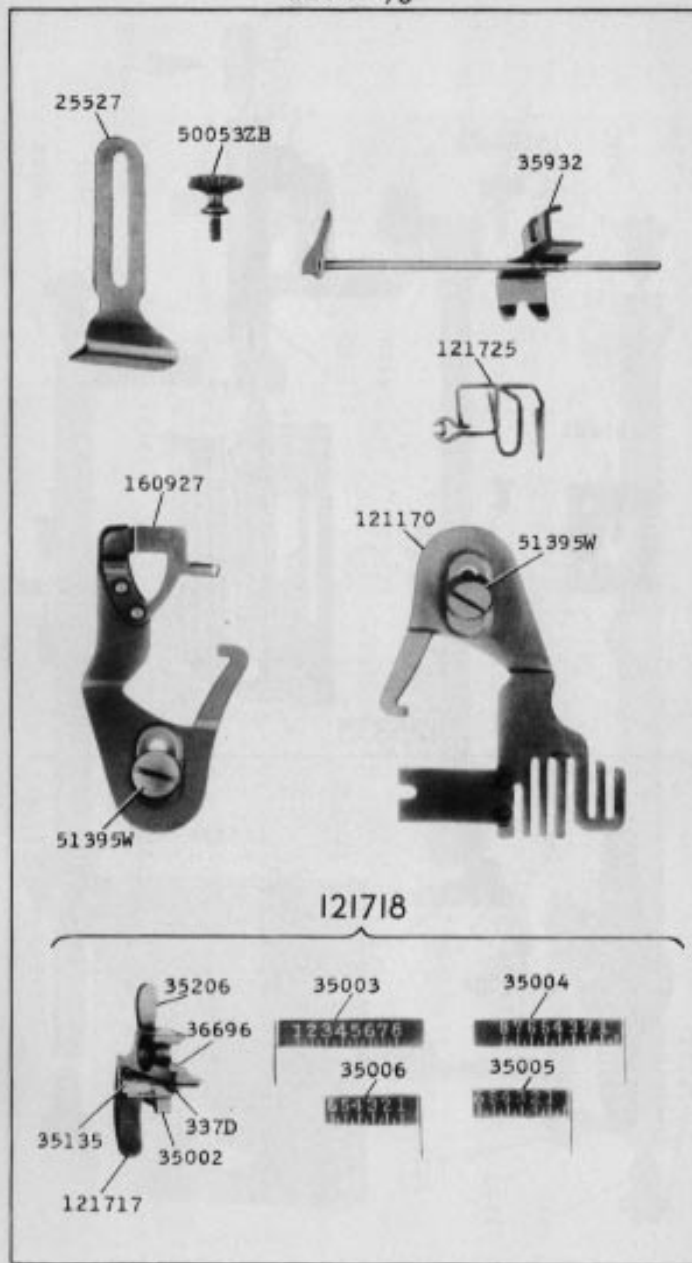

26102-2/3

51224ZB



45321



125261



208AL

173585

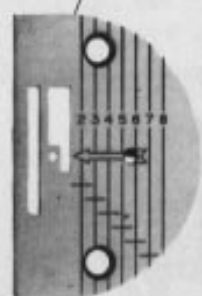

691BB

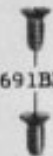

125338

125337



51282BA

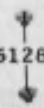

125336

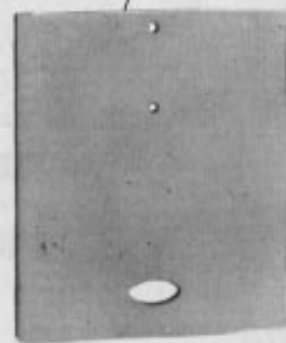

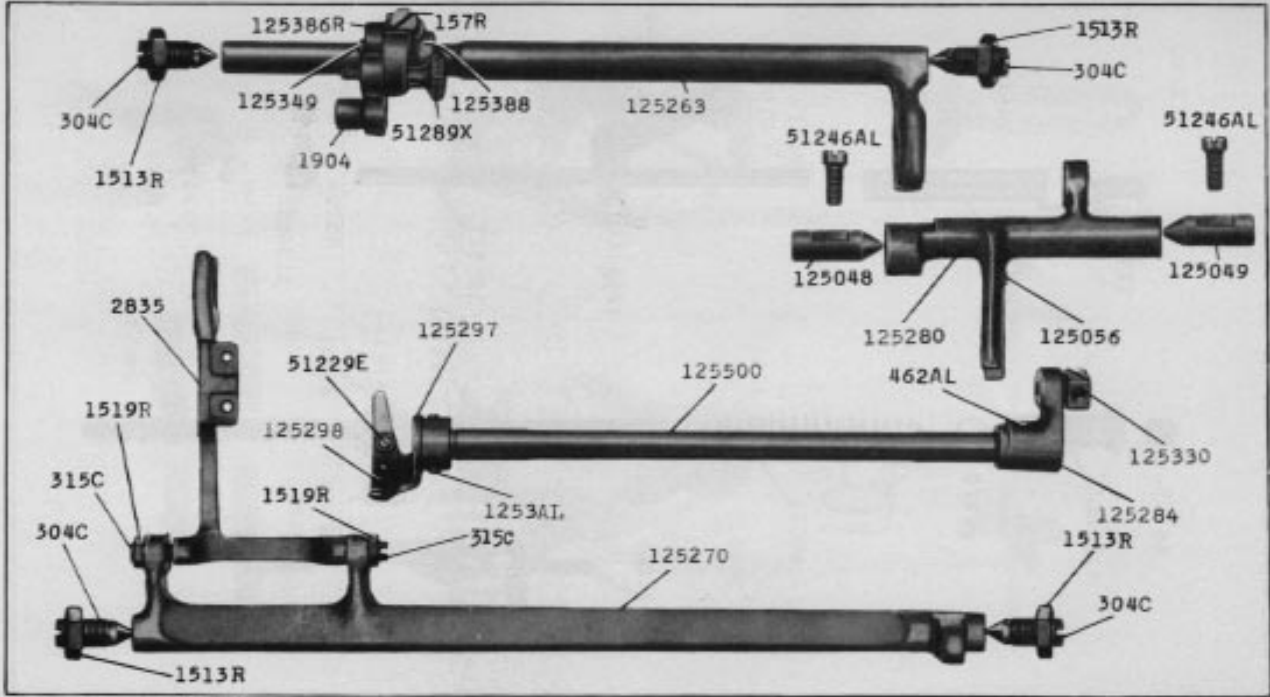

26103-1/2

26104-1/2

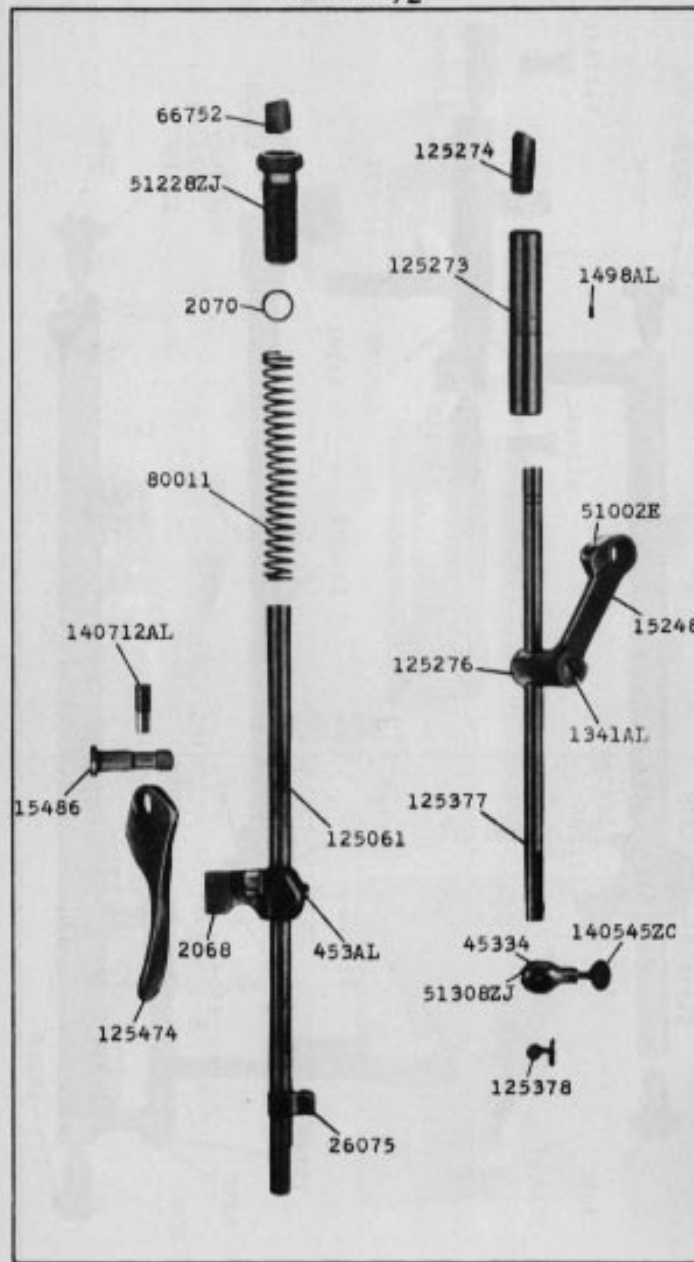

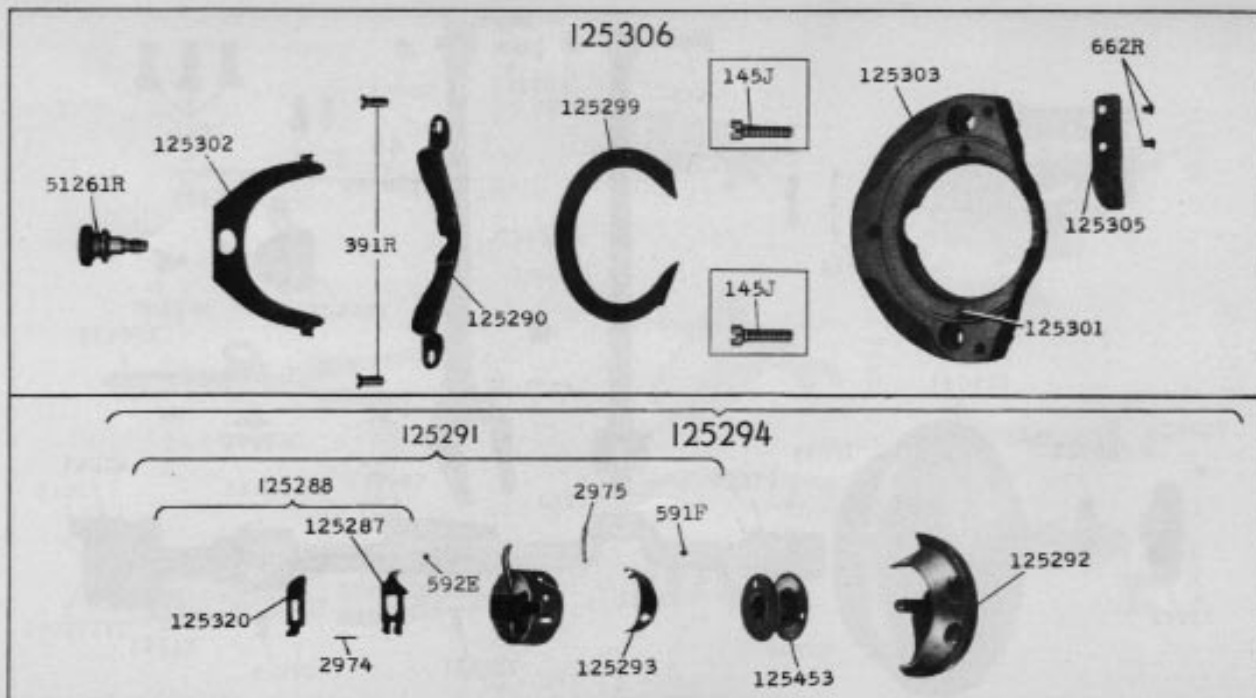

26105-1/2

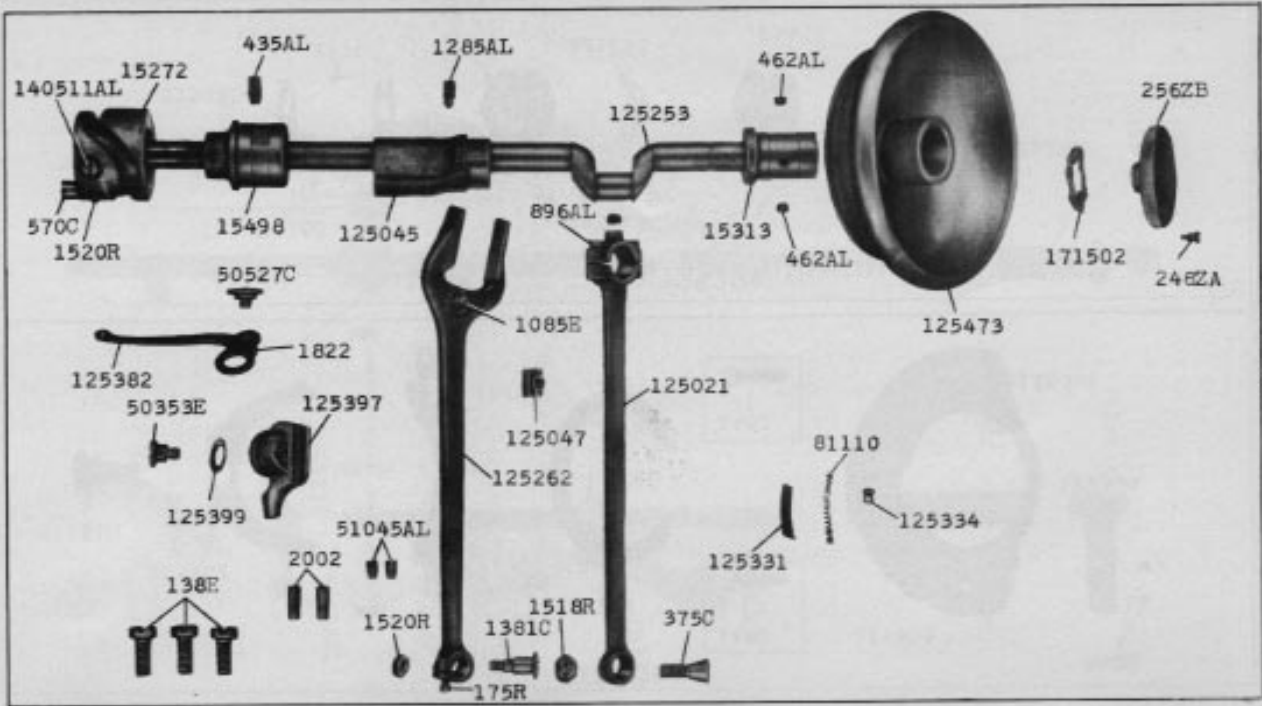

26106 1/3

26107.1/2

